

Package Contents / 包裝內容物 / Contenu du colis

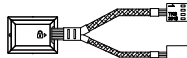

x 4 pcs



x 1 pc

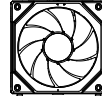

x 1 pc

**Power Cable Installation / 電源線安裝 /
Installation du câble d'alimentation**

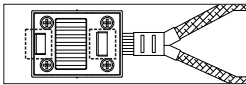

The socket for the power module are in different size, please be aware of the direction/
電源片分為大小兩種卡榫，安裝時須注意方向性/
La prise pour le module d'alimentation est entaille différente, veuillez faire attention à la direction

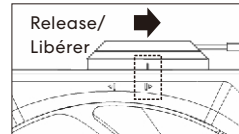
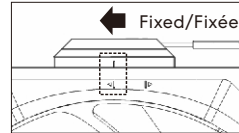
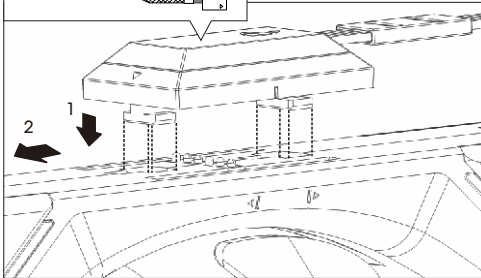
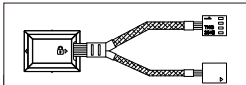

**Remove the Fan Interlocking Key/風扇扣鎖拆除/
Retirez la clé de verrouillage du ventilateur**

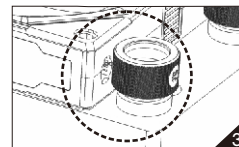
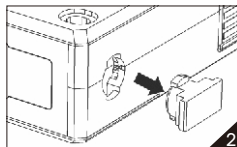
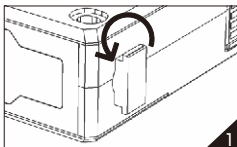

The fan interlocking key is removable if it is affected by the radiator inlet and outlet/

若遇到水冷排水位置影響風扇扣鎖，可將風扇卡扣鎖移除/

La clé de verrouillage du ventilateur est amovible si elle est affectée par l'entrée et la sortie du radiateur

**Fan to Fan Connection/風扇連接風扇/
Connexion ventilateur à ventilateur**

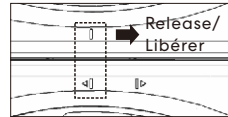
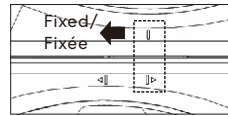
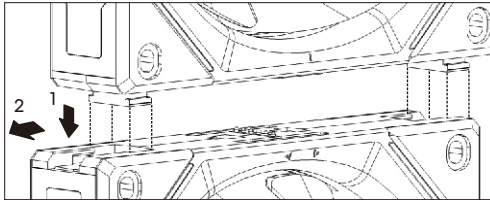

**Steps to Switch Orientation of the Cable on the Power Module/
電源片電線轉換方向示意/Étapes pour changer l'orientation du câble
sur le module d'alimentation**

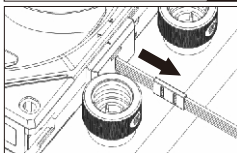
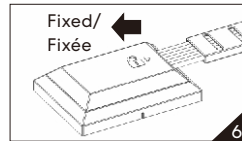
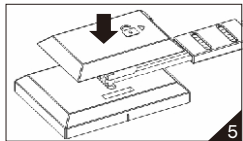
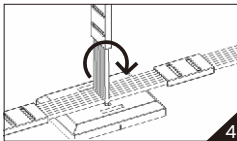
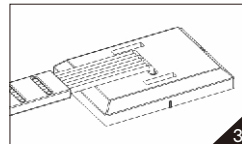
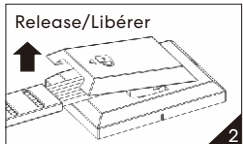
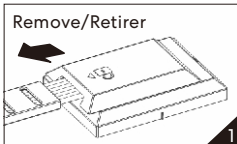

! The top cover is removable if it is affected by the radiator inlet and outlet, and route the cable vertically/若遇到水冷排水位置影響電源片上蓋，可將上蓋移除，以垂直方式走線/Le capot supérieur est amovible s'il est affecté par l'entrée et la sortie du radiateur, et acheminez le câble verticalement

**Power Module to Motherboard connection/電源片連接主板/
Connexion du module d'alimentation à la carte mère**

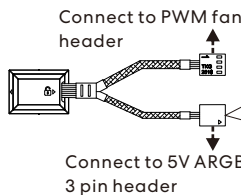

! Do not connect the wrong type of LED connector. If it is connected to the 12V connector, permanent damage will occur/請不要連接錯誤類型的LED接頭，如果連接到12V接口，將造成永久損壞/Ne connectez pas le mauvais type de connecteur LED. S'il est connecté au connecteur 12 V, des dommages permanents se produiront

5 V

X 12 V